

EXECUTIVE SERIES COLONIAL WITH ATTIC



Plan #TBM07-2981

Total living area: (1088 sq.ft / 97.92 sq.m)

Two-car Garage (544 sq. ft. / 49.50 sq. m.)

Foundation Option: Floating Slab

Contact
**LUMBER
MART**
for details
and pricing!

Special Features: Second level storage (550 sq. ft./49.50 sq.m.)

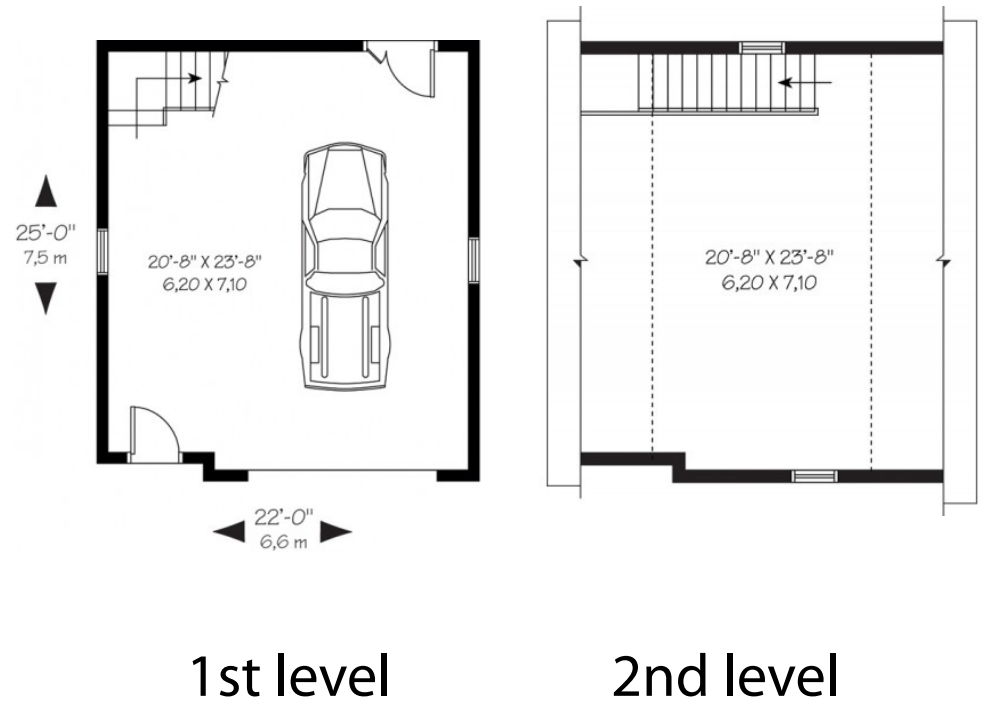

**HOME IMPROVEMENT
LIQUIDATION
WAREHOUSE**

- 751 Herring Cove Road,
Halifax, N.S.,
Tel. 477-6500

- 15 Wright Ave., Burnside,
Dartmouth, N.S.,
Tel. 468-7772

NEED HELP PLANNING YOUR NEW GARAGE?

Visit us online... lumbermart.ca/garages.aspx