

# EXECUTIVE SERIES STONEHOUSE GARAGE



## Plan #TBM07-2975

Total living area: (704 sq.ft / 63.36 sq.m)  
 One-car Garage: (384 sq. ft. / 34.56 sq.m.)  
 Bonus Space: (320 sq. ft. / 28.80 sq.m.)  
 Foundation Option: Floating Slab

Contact  
**LUMBER  
 MART**  
 for details  
 and pricing!

Special Features: Decorative shutters and second level storage

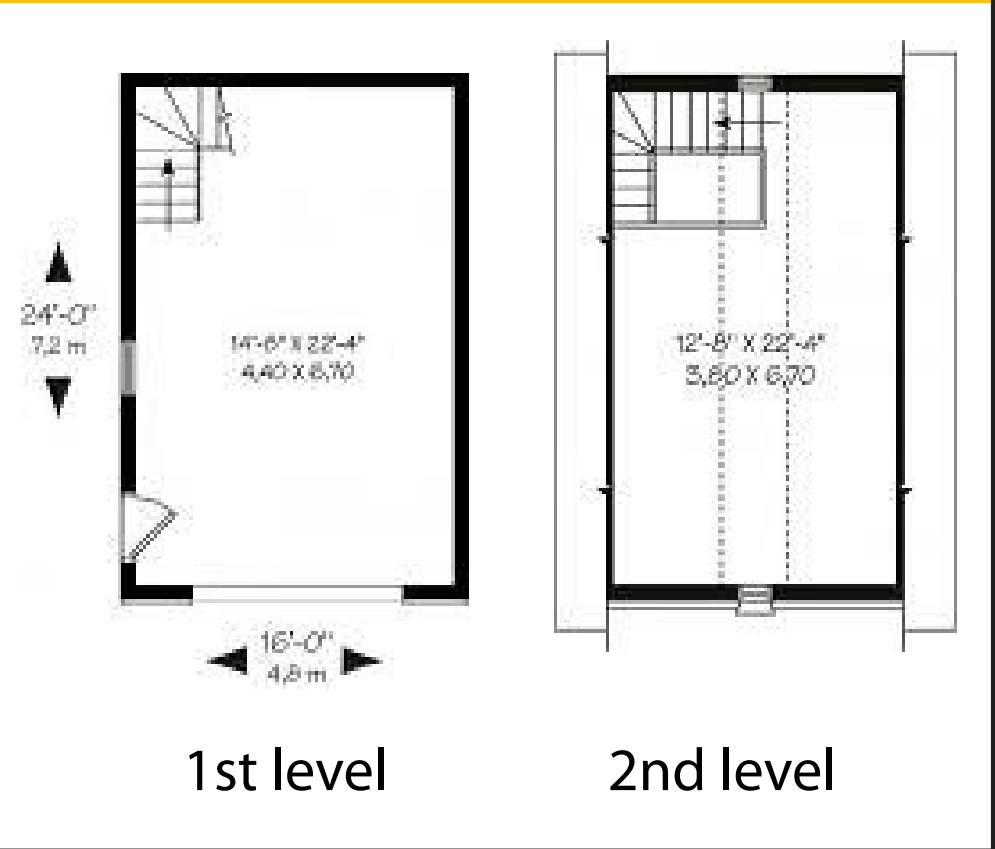

HOME IMPROVEMENT  
**LIQUIDATION  
 WAREHOUSE**

- 751 Herring Cove Road, Halifax, N.S., Tel. 477-6500
- 15 Wright Ave., Burnside, Dartmouth, N.S., Tel. 468-7772

**NEED HELP PLANNING YOUR NEW GARAGE?**

Visit us online... [lumbermart.ca/garages.aspx](http://lumbermart.ca/garages.aspx)